

#CPP934 - Installation Instructions

1" Rear Sway Bar for 1958-64 Fullsize Chevy

Instructions:

1. Attach the sway bar to the mounting bracket as shown in the illustration using the short bolts and U-bolts. The dip should be down.
2. With brackets attached to the bar, it should be held up under the car in position. The outer bend should be just forward of the shock absorber on the later models; on the earlier models the shock absorber is behind the axle; just be sure that the bar is just enough to the rear that it will not be struck by the tail pipe or any other part of the car.
3. With the bar in position against the bottom of the lower suspension control arm, mark it for drilling.
4. Drill the control arm with a 3/8" drill bit. Bolt the brackets to the control arms.
5. Road test the car, and familiarize yourself with your car's new handling characteristics.

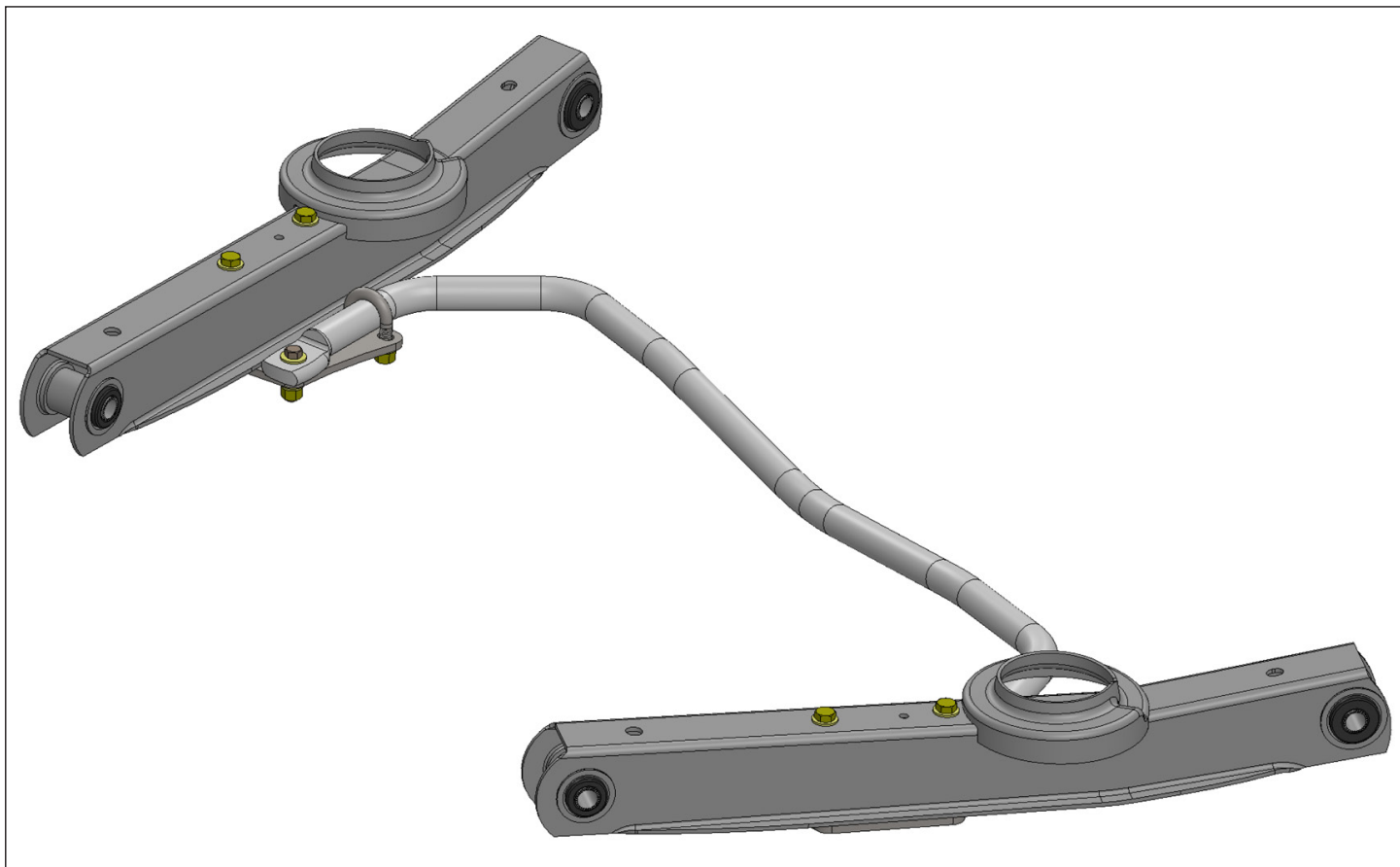

For technical help call Classic Performance Products Monday thru Friday 8:30am to 5:00pm at (714) 522-2000.

Classic Performance Products, Inc. 714.522.2000 | fax 714.522.2500
378 E. Orangethorpe Ave. | Placentia, CA 92870 | www.classicperform.com