

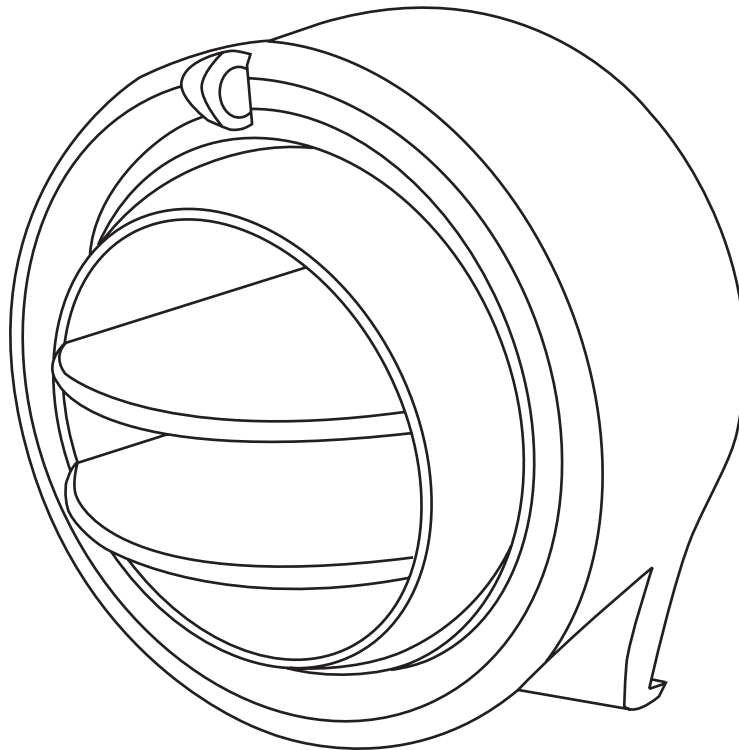

an ISO 9001:2008 Registered Company

1967-72 Chevrolet Pickup

without **Factory Air
Louver Kit
(498827)**



18865 Goll St. San Antonio, TX 78266
Phone: 210-654-7171
Fax: 210-654-3113
www.vintageair.com



www.vintageair.com

Table of Contents

Cover.....	1
Table of Contents.....	2
Packing List/Parts Disclaimer.....	3
Dash Modification.....	4
Louver Assembly & Installation.....	5
Packing List.....	6



www.vintageair.com

Packing List: Louver Kit (498827) **1967-72 Chevrolet Pickup** **without Factory Air**

No.	Qty.	Part No.	Description
1.	1	49775-LCI	Ball Housing, Driver Side
2.	1	49776-LCI	Ball Housing, Passenger Side
3.	2	495560	Louver Ball Retainer
4.	2	495561	Hose Adapter, 2 1/2"
5.	2	49769-LCI	Ball Louver
6.	2	213011	Tie Wrap, 14 1/2"
7.	4	182467	Screw, #8 x 3/4", Sheet Metal
8.	2	182468	Screw, #8 x 2", Sheet Metal
9.	1	642499	Louver Drill Guide, Driver Side
10.	1	642500	Louver Drill Guide, Passenger Side

**** Before beginning installation, open all packages and check contents of shipment.**
Please report any shortages directly to Vintage Air within 15 days. After 15 days,
Vintage Air will not be responsible for missing or damaged items.

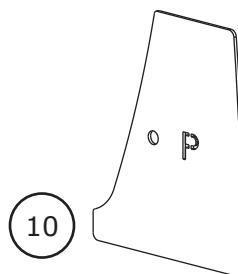
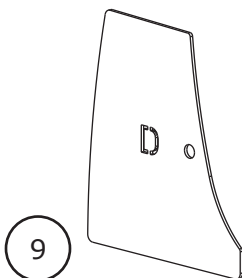
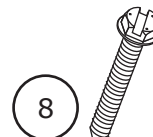
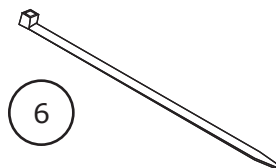
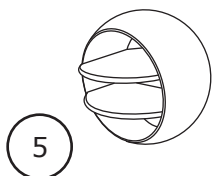
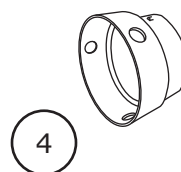
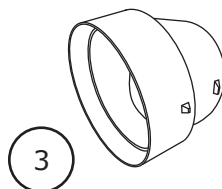
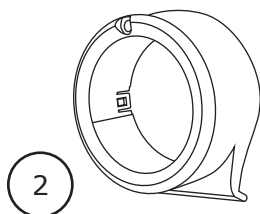
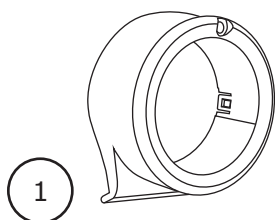

NOTE: Images may not depict actual parts and quantities.
Refer to packing list for actual parts and quantities.



www.vintageair.com

Dash Modification

1. Locate the louver installation locations on the dash. To protect the dash from scratches, apply painter's tape to the louver installation locations as shown in Photo 1, below. **NOTE: The painter's tape should cover a minimum 3 5/8" diameter to include the 3 1/2" drilled hole and an additional 1/8" to protect the outer edges.**
2. Locate the driver side drill guide, which is marked D. Place the drill guide on the flat area of the dash, pressing against the door pillar as shown in Photo 1, below. Mark or scribe the center of the hole.
3. Remove the drill guide. Center punch, and then drill a 1/4" hole in the dash.
4. Using a 3 1/2" hole saw, drill horizontally into the dash, cutting the raised portions first. After drilling, clean up the edges of the hole using a half-round or rat-tail file.
5. Place the driver side ball housing into the hole, making sure it fits properly all around.
6. If the fit is satisfactory, mark or scribe the (3) screw holes. Center punch and drill (3) 1/8" holes.
7. Using the passenger side drill guide, which is marked P, repeat Steps 2-6, above, for the passenger side dash modification.

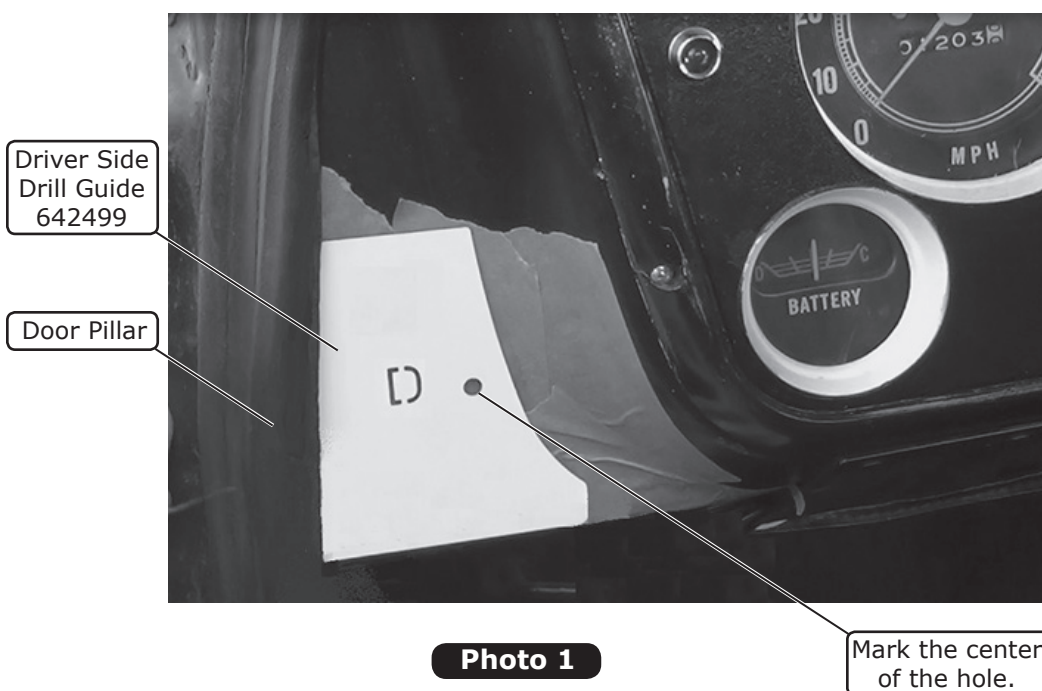

Photo 1



www.vintageair.com

Louver Assembly & Installation

1. Cut one felt strip into (5) pieces. Attach the (5) pieces to the inside of the driver side ball housing and the louver ball retainer as shown in Photo 2, below.
2. Snap together the driver side ball housing, ball louver and louver ball retainer as shown in Photo 3, below.
3. Install a tie wrap around the louver assembly snaps to keep them from coming loose (See Photo 4, below).
4. Attach the 2 ½" hose adapter to the 2 ½" duct hose in the dash (See Photo 5, below).
5. Align the holes on the 2 ½" hose adapter with the barbs on the louver assembly as shown in Photo 6, below. Snap the louver assembly into the 2 ½" hose adapter.
6. Install the louver assembly into the dash, and secure it using (1) #8 x 2" sheet metal screw on the top and (2) #8 x 3/4" sheet metal screws on the bottom.
7. Repeat Steps 1-6, above, for the passenger side louver assembly.

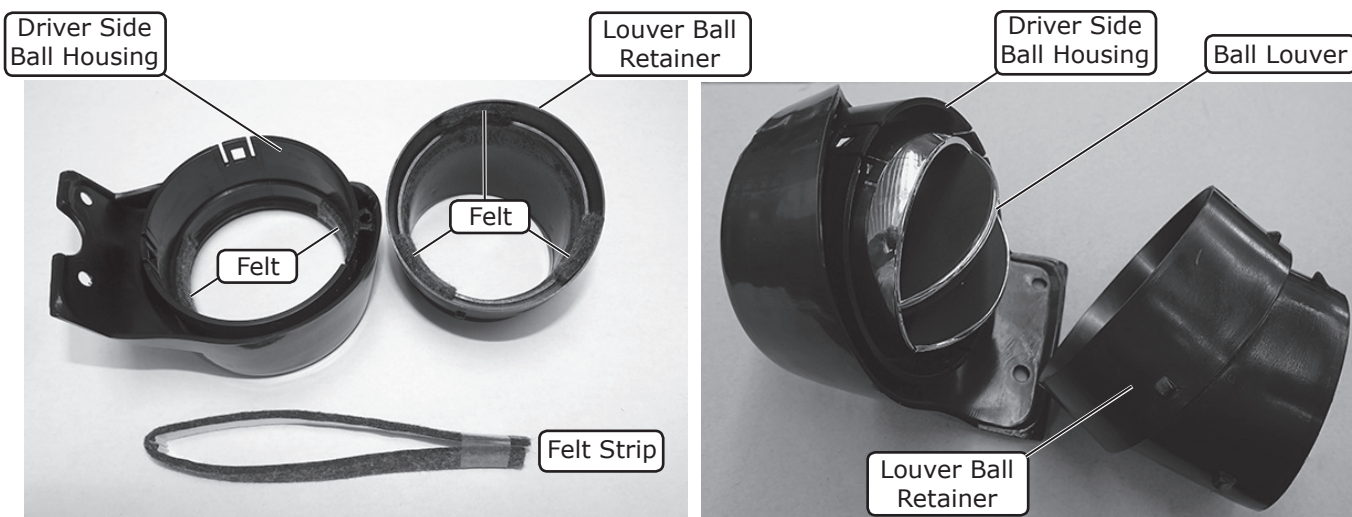

Photo 2

Photo 3

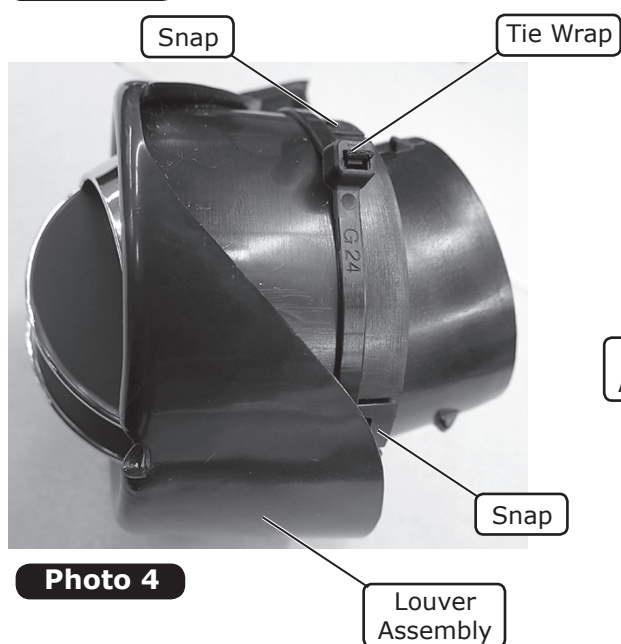

Photo 4

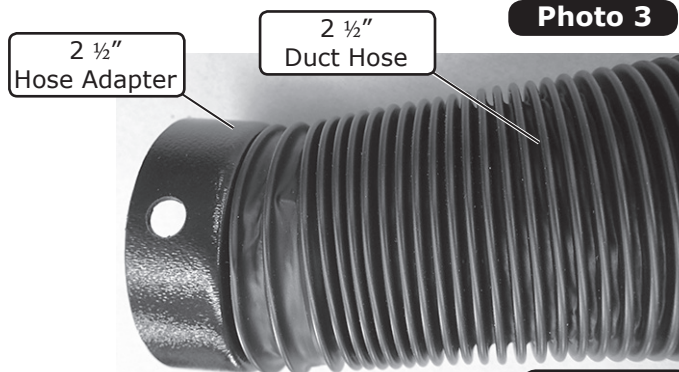

Photo 5

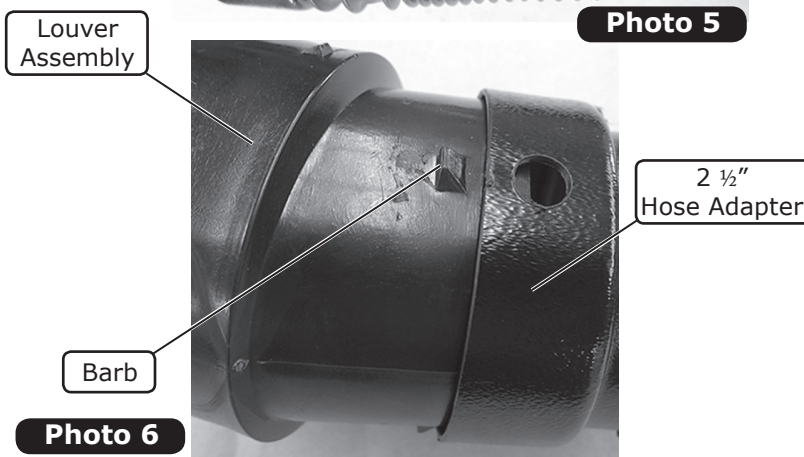

Photo 6



www.vintageair.com

Packing List: Louver Kit (498827) 1967-72 Chevrolet Pickup without Factory Air

No.	Qty.	Part No.	Description	
1.	1	49775-LCI	Ball Housing, Driver Side	_____
2.	1	49776-LCI	Ball Housing, Passenger Side	_____
3.	2	495560	Louver Ball Retainer	_____
4.	2	495561	Hose Adapter, 2 1/2"	_____
5.	2	49769-LCI	Ball Louver	_____
6.	2	213011	Tie Wrap, 14 1/2"	_____
7.	4	182467	Screw, #8 x 3/4", Sheet Metal	_____
8.	2	182468	Screw, #8 x 2", Sheet Metal	_____
9.	1	642499	Louver Drill Guide, Driver Side	_____
10.	1	642500	Louver Drill Guide, Passenger Side	_____

Checked By: _____
Packed By: _____
Date: _____

